

Mounting manual balloon arch

1



Place the foot parts a few meters (about 3 meters) apart from each other on the ground.

2

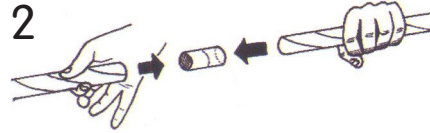

Connect the tubes to each other, by means of the included coupling pieces, until the desired length had been reached.

3



Place the tubes in the foot parts and press down firmly. Also check that all tubes are pressed down firmly (tape them together with scotch tape if necessary).

4

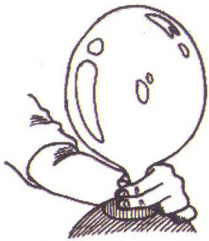

Inflate 2 balloons to the same size.

5

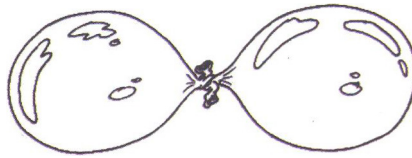

Knot these balloons together.

6

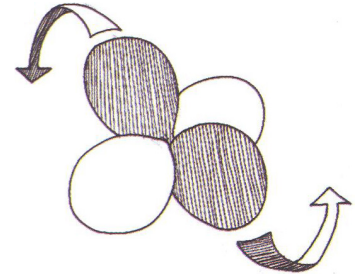

Again inflate 2 balloons and knot together. Curl up these with the other balloons into a bunch of 4 pieces.

7

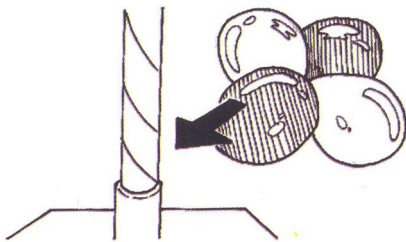

Slide a cluster of 4 balloons to the tube, so that the pipe is in the center.

8

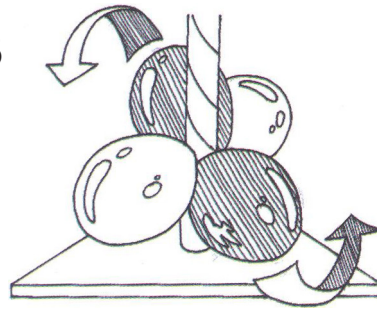

Wrap the balloons around each other so that they are clamped firmly to the tube.

9

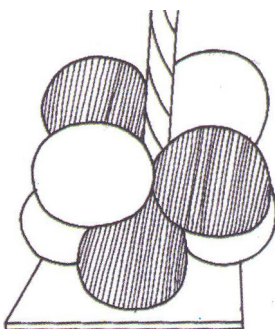

Repeat step 4 to 6 and place the next cluster of 4 on top of the last one.

10

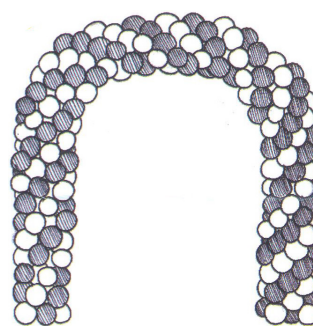

Repeat until the whole tube is filled with balloons.